

Product Data Sheet

HTK70AA

Variant Code 3^{*}

Revision 3

1 Application

Application	Refrigerant	Expansion Device	Cooling Type
LBP	R600a	Capillary	Static

1.1 Application Conditions

Max. Ambient temp. ¹	[°C]	43
Max. Steady discharge temp. ²	[°C]	120
Max. Peak discharge temp. ^{2,5}	[°C]	135
Max. Steady condensing temp. ³	[°C]	60
Max. Peak condensing temp. ^{3,5}	[°C]	70
Max. Winding temp. ⁴	[°C]	130

¹ ...static

² ...measured on discharge tube, 50 mm from the shell

³ ...measured in the middle of condenser

⁴ ...calculated out of the measured difference of resistance

⁵ ...max 5% of lifetime

* ...Variant code according to Label; see General Product Documentation

2 Mechanical Data

Displacement	[cm ³]	6.6
Net Weight ¹	[kg]	7,9
Oil Type		mineral
Oil Charge	[ml]	165
Oil Viscosity	[cst]	5
Suction muffler		Semi direct
Free Gas Volume	[cm ³]	1500
Length L	[mm]	237,5
Width W	[mm]	151,5
Height H	[mm]	159

¹...Compressor without accessories

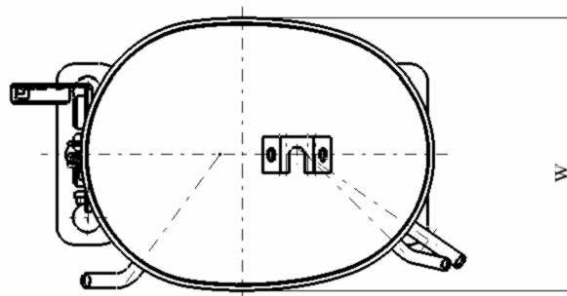
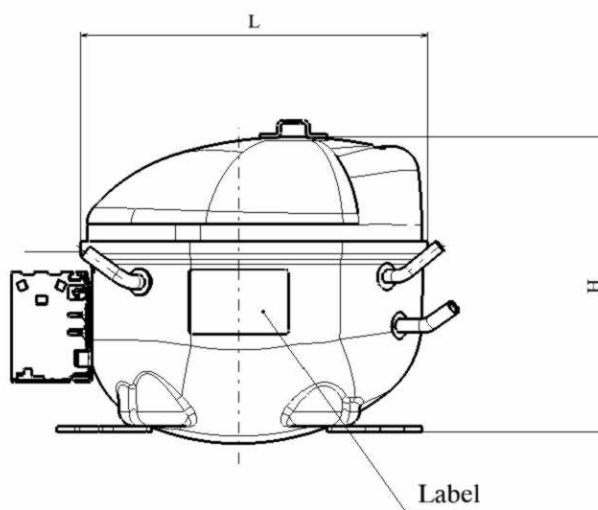

3 Electrical Data

Power supply	[V]	220 - 240
Voltage range ¹	[V]	187 – 264
Frequency	[Hz]	50
Phase	[ph]	1
Motor type		RSIR/RSCR
Rated current / Locked rotor current @ steady state	[A]	0,58 / 2,92
Max. Locked rotor current measured after 4 sec	[A]	10,9 / 3,4
Main wind. Resistance @ 25°C	[Ω]	35,3
Start wind. Resistance @ 25°C	[Ω]	16,3

¹...@ +43°C windings temperature – 3,5 barA equalized pressure

All data measured according to EN 60335

3.1 Electrical Component Data

Terminal board		ECC
Starting device	Code	K100
PTC	Type	A
Run Capacitor	[μF]	2,5; 3: 4

3.2 Motor Protector

Motor Protector	BDG	Wanbao	Sensata
Type	AE37FJ x	B59 115 x	4TM 189 NFB YY x
Code	F7	MF	69

4 Performance Data

4.1 COP, Cooling Capacity and Input Power

Performance Table COP with RC @ ASHRAE / EN12900 (CECOMAF); 220V, 50Hz; [W/W]:

Evap. temp. [°C]		-35	-30	-25	-23,3	-20	-15	-10	
Co nd en sin g te mp . @	ASHRAE [°C]	40	1,19	1,52	1,84	1,96	2,17	2,50	2,83
		45	1,16	1,46	1,76	1,86	2,05	2,35	2,65
		50	1,14	1,40	1,67	1,76	1,94	2,21	2,47
		55	1,11	1,35	1,58	1,66	1,82	2,06	2,30
		60	1,08	1,29	1,50	1,57	1,71	1,91	2,12
	EN12900 (CECOMAF) [°C]	C55	0,91	1,11	1,30	1,37	1,49	1,69	1,89

Performance Graph COP with RC:

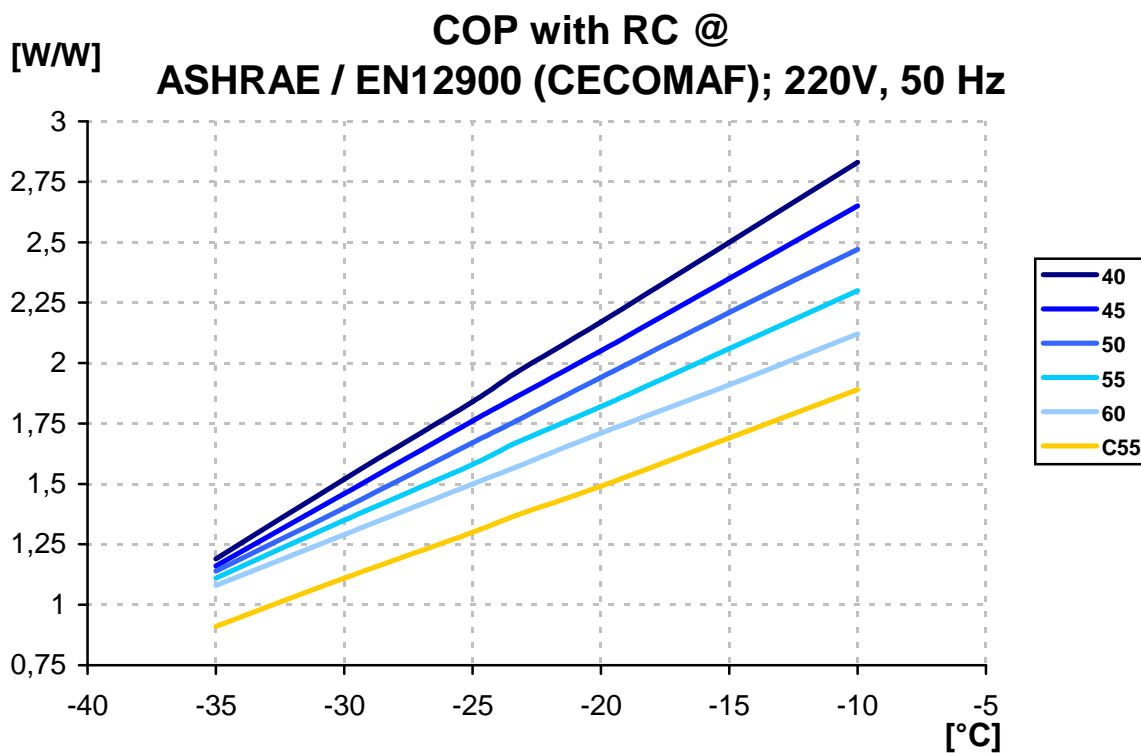

Performance Table COP without RC @ ASHRAE / EN12900 (CECOMAF); 220V, 50Hz; [W/W]:

Evap. temp. [°C]		-35	-30	-25	-23,3	-20	-15	-10	
Co nd en sin g te mp . @	ASHRAE [°C]	40	1,13	1,46	1,78	1,89	2,11	2,44	2,76
		45	1,10	1,40	1,70	1,80	1,99	2,29	2,59
		50	1,07	1,34	1,61	1,70	1,88	2,15	2,42
		55	1,04	1,29	1,53	1,61	1,77	2,01	2,25
		60	1,02	1,23	1,44	1,51	1,65	1,86	2,08
	EN12900 (CECOMAF) [°C]	C55	0,86	1,07	1,25	1,32	1,45	1,65	1,85

Performance Graph COP without RC:

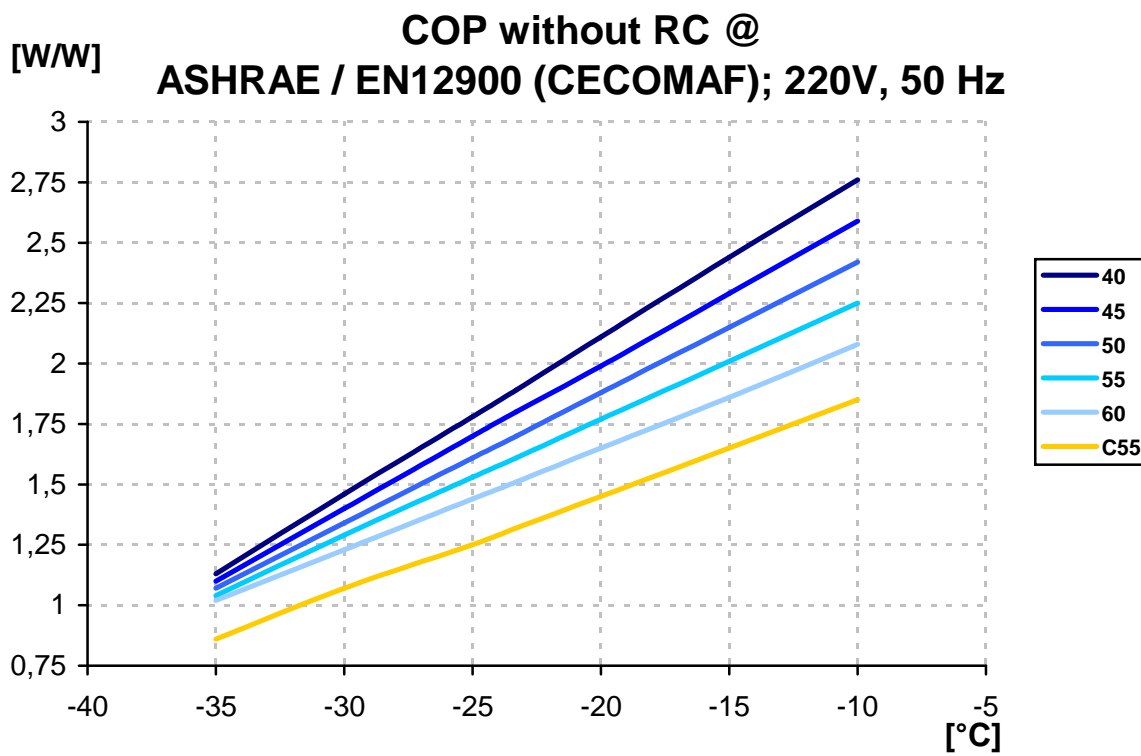

HTK70AA K3

Variant Code 3



Performance Table Cooling Capacity @ ASHRAE / EN12900 (CECOMAF); 220V, 50Hz; [W]:

Evap. temp. [°C]		-35	-30	-25	-23,3	-20	-15	-10	
Co nd en sin g te mp . @	ASHRAE [°C]	40	61,9	84,5	112,5	123,2	145,9	184,7	229,0
		45	59,2	82,0	110,3	121,2	144,1	183,3	228,0
		50	56,4	79,5	108,1	119,1	142,2	181,8	227,0
		55	53,7	77,0	105,9	117,0	140,4	180,4	226,0
		60	50,9	74,5	103,7	114,9	138,5	179,0	225,0
	EN12900 (CECOMAF) [°C]	C55	44,0	63,0	87,0	96,0	115,0	148,0	185,0

Performance Graph Cooling Capacity:

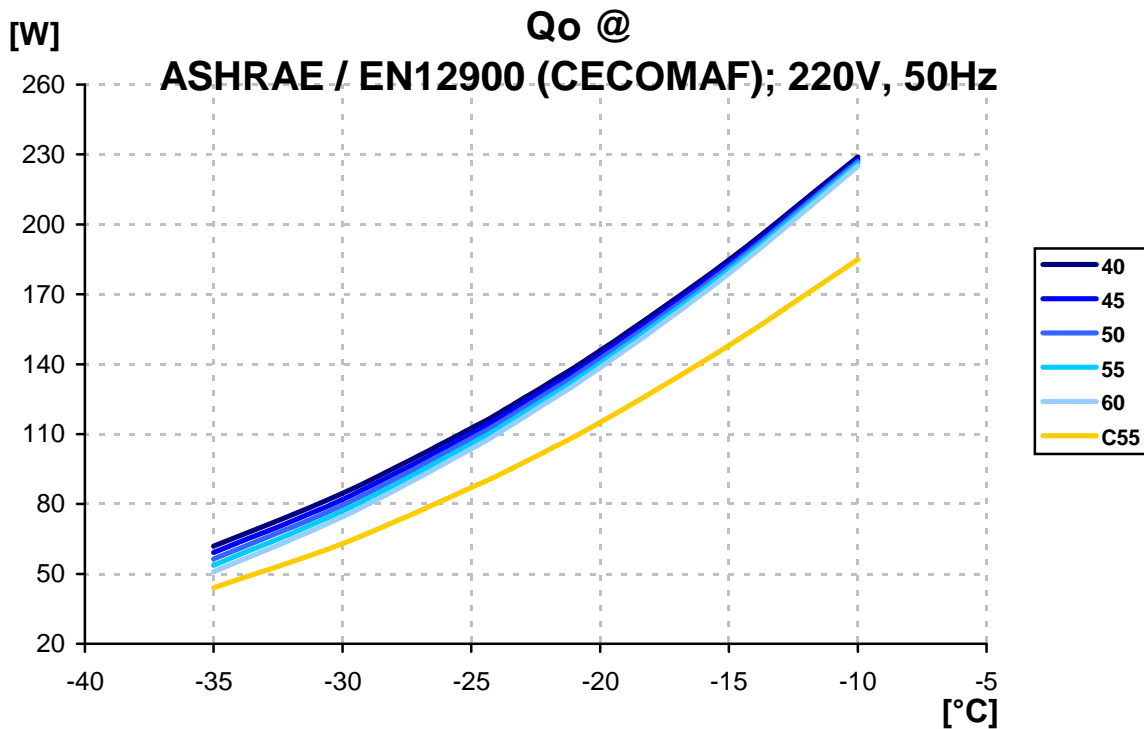

Secop reserves the right to change the data without prior notice

Performance Table Input Power with RC @ ASHRAE / EN12900 (CECOMAF); 220V, 50Hz; [W]:

Evap. temp. [°C]		-35	-30	-25	-23,3	-20	-15	-10	
Co nd en sin g te mp . @	ASHRAE [°C]	40	52,1	55,7	61,0	63,0	67,2	73,9	81,0
		45	50,9	56,2	62,8	65,2	70,1	77,9	86,0
		50	49,7	56,7	64,7	67,6	73,4	82,4	91,8
		55	48,4	57,2	66,8	70,3	77,0	87,6	98,3
		60	47,1	57,8	69,2	73,3	81,2	93,5	106,0
	EN12900 (CECOMAF) [°C]	C55	48,4	57,2	66,8	70,3	77,0	87,6	98,3

Performance Graph Input Power with RC:

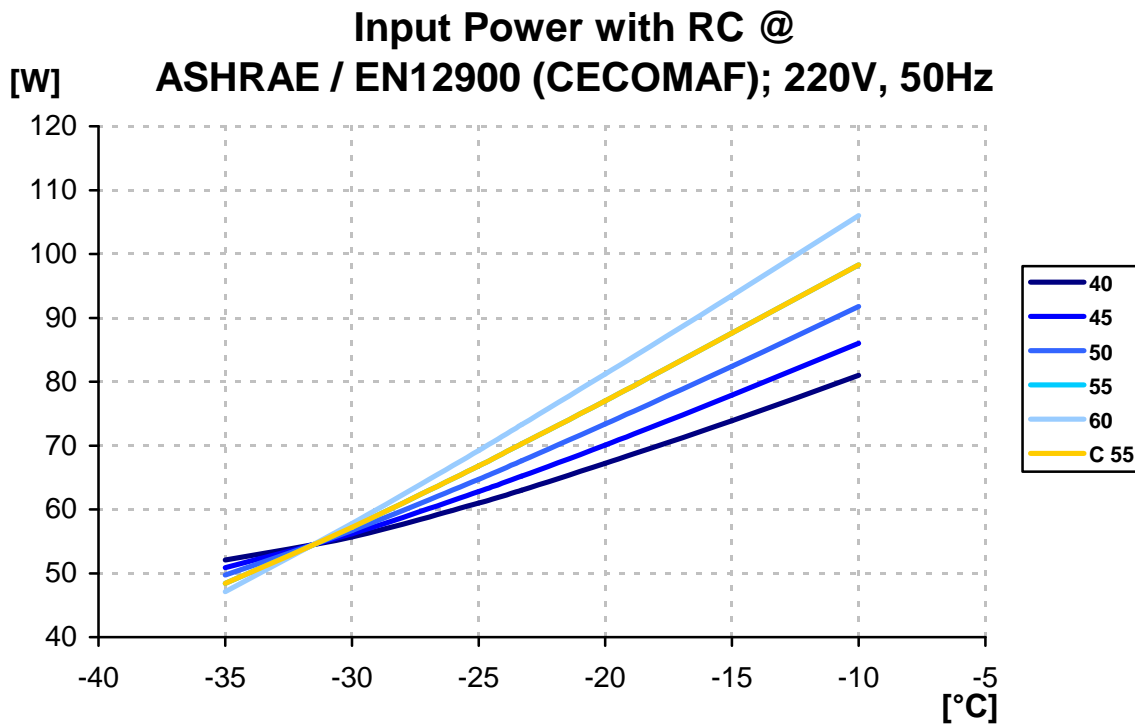

Performance Table Input Power without RC @ ASHRAE / EN12900 (CECOMAF); 220V, 50Hz; [W]:

Evap. temp. [°C]		-35	-30	-25	-23,3	-20	-15	-10	
Co nd en sin g te mp . @	ASHRAE [°C]	40	53,2	57,0	62,4	64,5	68,8	75,6	82,9
		45	52,6	57,9	64,5	67,0	71,9	79,8	88,0
		50	52,0	58,8	66,8	69,7	75,5	84,5	93,8
		55	51,3	59,0	69,4	72,8	79,5	89,9	100,6
		60	50,7	61,1	72,3	76,2	84,0	96,1	108,5
	EN12900 (CECOMAF) [°C]	C55	51,3	59,0	69,4	72,8	79,5	89,9	100,6

Performance Graph Input Power without RC:

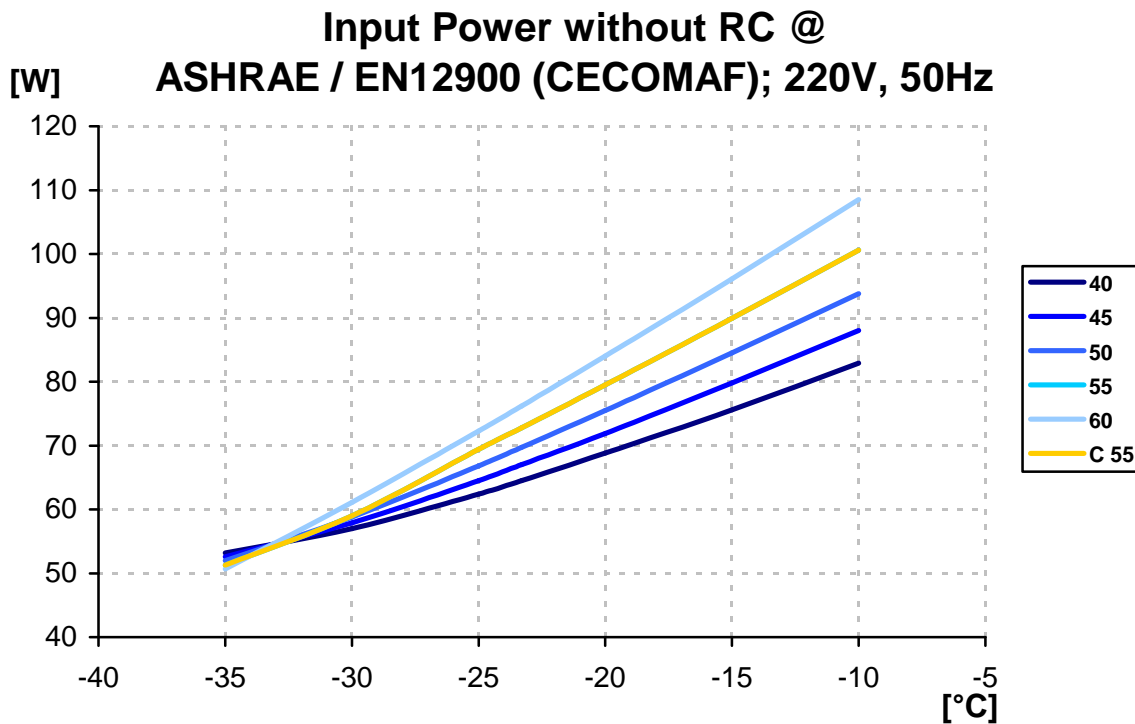

Test Conditions @ 220V/50Hz		ASHRAE	EN12900 (CECOMAF)
Evaporating temp.	[°C]	-23,3	-25
Condensing temp.	[°C]	55	55
Sub cooling temp.	[°C]	32	55
Suction temp.	[°C]	32	32
Ambient temp.	[°C]	32	32

Tolerance Range:

COP	+/-7%
Cooling Capacity	+/-5%

4.2 Rated current @ 55°C condensing temperature

Evaporating temperature	[°C]	-30	-23,3	-10
Rated current with RC	[A]	0,25	0,31	0,43
Rated current without RC	[A]	0,38	0,42	0,52

5 Reliability Tests

High Temperature CECOMAF GT4 – 002	passed
Wear CECOMAF GT4 – 003	passed
On – Off CECOMAF GT4 – 004	passed
Transport test ASTM D4728	passed